

THOR HELICAL CRACK STITCHING BAR
 1/4"(6mm) dia. x39"long



- MATERIAL: AUSTENITIC STAINLESS STEEL, GRADE 304, AVAILABLE IN GRADE 316, AS SPECIAL ORDER.
- ULTIMATE TENSILE STRENGTH: 1486kip/in² - 1777 kip/in²
- GROUT: WHD-60 GROUT IS A CEMENTITIOUS THIXOTROPIC, SHRINK COMPENSATED GROUT FORMULATED WITH A SPECIAL BLEND OF POLYMERIC REINFORCING RESINS THAT BOND STEEL TO MASONRY AND MASONRY TO MASONRY.

CRACK STITCHING INSTALLATION SPECS:

CRACK STITCHING TO BE PERFORMED USING 1/4 INCH (6MM) X 39 INCHES LONG, STAINLESS STEEL, GRADE 304 THOR HELICAL CRACK STITCHING BARS, AS MANUFACTURED BY THOR HELICAL.

* CRACK STITCHING WORK SHALL BE PERFORMED BY A THOR CERTIFIED INSTALLER.

FOLLOW MANUFACTURER'S INSTALLATION INSTRUCTIONS AND METHODS, AND CONSULT WITH ENGINEER FOR INTERPRETATION OF ANY CONFLICTS.

SEQUENCE OF INSTALLATION:

1. CUT SLOT INTO THE HORIZONTAL MORTAR JOINT TO A DEPTH OF 1-1/2 INCHES. CUT SLOT 20 INCHES ON BOTH SIDES OF CRACK.
2. HEIGHT OF SLOT SHALL BE EQUAL TO FULL HEIGHT OF THE HORIZONTAL MORTAR JOINT.
3. REMOVE ALL MORTAR AND DUST FROM THE SLOTS AND THOROUGHLY FLUSH WITH WATER.
4. INJECT WHD-60 GROUT, HIGH PERFORMANCE GROUT, AND FILL SLOT WITH APPROXIMATELY 3/8 INCH TO 1/2 INCH DEEP INTO THE BACK OF THE JOINT.
5. IN HOT CONDITIONS ENSURE THE MASONRY WALL IS WELL WETTED OR PRIMED TO PREVENT PREMATURE DRYING OF THE WHD-60 GROUT DUE TO DE-WATERING. WET THE SLOT JUST PRIOR TO INJECTING THE WHD-60 GROUT.
6. INSERT 1/4 INCH (6mm) DIA. CRACK STITCHING BAR. IN SLOT. HELICAL BAR SHALL EXTEND 19.5 INCHES MIN. ON BOTH SIDES OF THE CRACK.
7. IF TWO OR MORE ADJACENT CRACKS ARE BEING STITCHED TOGETHER PLACE CRACK STITCHING BAR 19.5 INCHES BEYOND OUTER CRACK VERTICAL SPACING BETWEEN HELICAL BARS SHALL NOT EXCEED 24 INCHES.
8. WHERE CRACKS ARE LESS THAN 18 INCHES FROM A CORNER CONTINUE HELICAL BAR AROUND CORNER OF THE WALL FOR A MINIMUM OF 15 INCHES AND BOND INTO ADJOINING WALL. IF REQUIRED LENGTH EXCEEDS 39 INCHES USE THOR LONG BARS AND CUT TO LENGTH.
10. INJECT A SECOND BEAD OF WHD-60 GROUT OVER THE EXPOSED HELICAL BAR AND PACK IT INTO THE SLOT USING FINGER TRUWEL. INJECT ADDITIONAL WHD-60 GROUT, IF NECESSARY. LEAVE 3/4 INCH SPACE FOR POINTING.
11. POINT THE OPENING IN THE SLOT (MORTAR JOINT) WITH SUITABLE MATCHING MORTAR.
12. ANY MISSING OR POOR QUALITY MASONRY MUST BE REPLACED.
13. PATCH CRACK WITH SILICONE BUILDING SEALANT OR OTHER PATCHING MATERIAL THAT MATCHES BRICK AND FOLLOW MANUFACTURER'S INSTRUCTIONS.

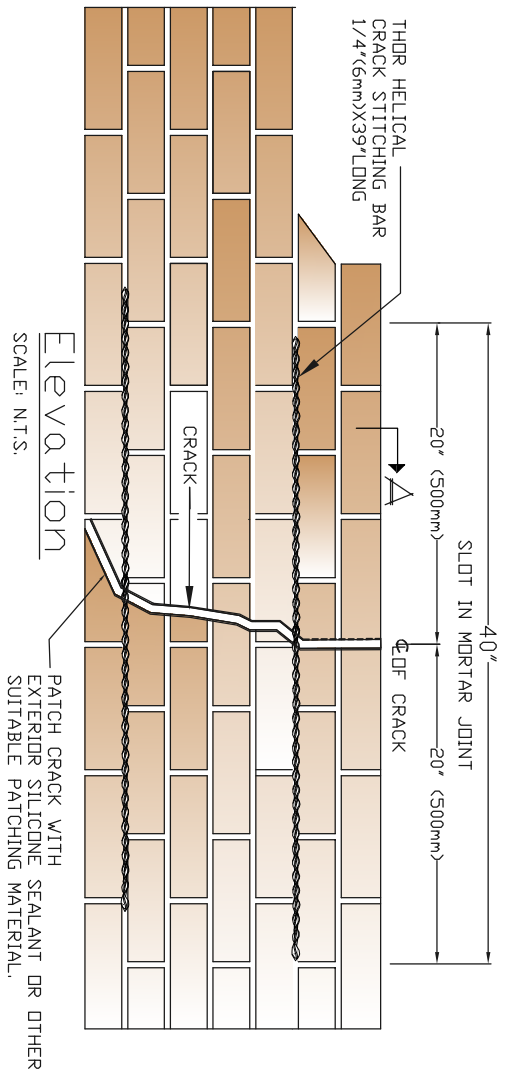

Elevation
SCALE: N.T.S.

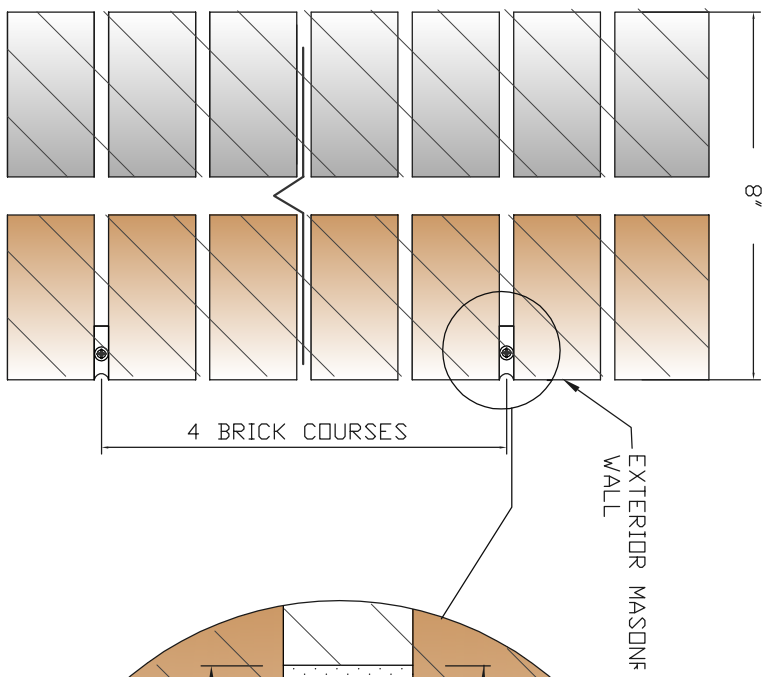

Section A
SCALE: N.T.S.

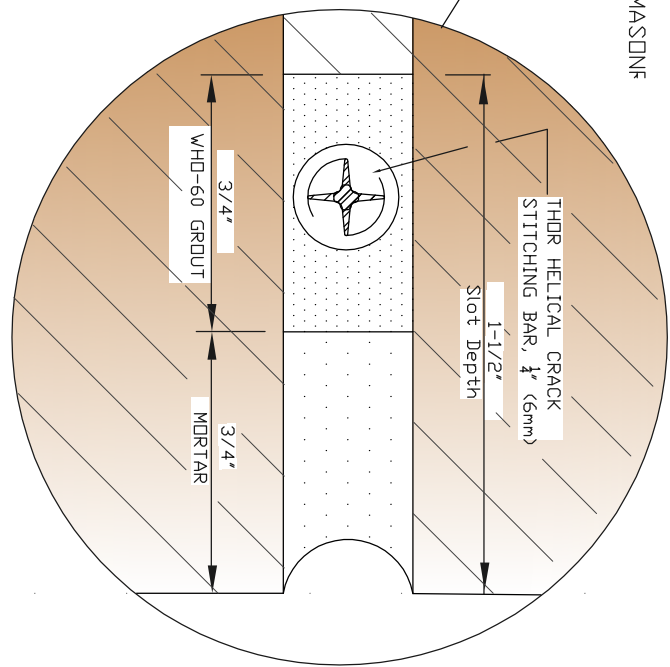

Joint Detail
SCALE: N.T.S.

340 West Passaic Street
 Rochelle Park NJ 07662
 TEL: 201 880-8819
 WWW.THORHELICALUSA.COM
 SUPPORT@THORHELICALUSA.COM

THORHELICAL® - USA

CAT.NO.: M60-1000-A2

DATE: January 2, 2017 SCALE: Not To Scale Drawing No.:

PROJECT: TYPICAL DETAIL **C-201**