

homewardbath

OPERATION & INSTRUCTION MANUAL

(6kW, 9kW & 12kW Steam Generator & Control Panel)



Mandatory Reading Installation Updates- Page 4

Parts Request Info- Page 19

Note: SAVE SALES RECEIPT for proof of purchase/warranty

Table of Contents

Read Me First	1
Safety Warnings	2
Safety Warnings In French	3
Mandatory Reading	4
Part 1: Steam Generator	
Choosing a Proper Size and Location	5
Steam Equipment Installation Diagram	6
Installation of the Pipeline	7
Steam Generator Blueprint	8
Electrical Requirements	8
Power Line Assembly Illustration	9
Wiring Diagram 220-240V (1PH/2PH)	10
Installation of the Top Light	11
Now Available	11
Steam Generator Configuration	12
Troubleshooting Guide	13
Instructions for Resetting Manual Hi-Limit	14
Specifications	15
Part 2: Control Panel	
Control Panel Blueprint	15
Controller Installation Instruction	16
Temperature Detector Installation	17
Controller Panel Illustration	17
Operation Instructions	18
Parts Request Instructions	19
Warranty Registration Instructions	19
Notes	20

*****SAVE THESE INSTRUCTIONS!**

READ AND FOLLOW ALL INSTRUCTIONS.

*****Ces instructions sont à conserver soigneusement!**

ETUDIER ET ENSUITE SE CONFORMER À TOUTES LES
INSTRUCTIONS

If parts are needed, please visit the “Support”
tab at www.homewardbath.com

READ ME FIRST

Verify the parts checklist to ensure that all necessary parts have been received.

When connecting the keypad and/or the keypad extension wire to the Steam Generator cable, **DO NOT TWIST THE PLUGS** together, twisting will damage the pins and it is not covered under the warranty.

The Temperature detector foundation and locknut for temperature detector foundation (escutcheon) for the temperature sensor is taped to the inside lip of the keypad box. Also included is the Steam Head.

When attaching the steam head to the steam line, do not tighten the steam head all the way down. If you do, it will restrict the flow of the steam. You should thread the steam head about 3/8 inch onto the steam line.

Light kits are available for the GS08 Steam Generators. White lights and chromotherapy lights are available.

Call: 866-783-2661

COMMON INSTALLATION PROBLEMS:

99% of the issues with these units upon the first power up can be traced to one of two items:

1. Is the unit connected to 220v? The unit has no neutral wire just L1, L2 and Ground. To properly test for the 220v you must test the L1 and L2 wires together and you should get 220v. If you test individually the L1 and L2 that can give you a false reading.
2. Is the wiring that connects the keypad to the steam generator damaged? Pull apart the connections (there are two, one near the keypad and one near the steam engine) and make sure none of the pins are bent or missing. If any are bent or missing replace the appropriate cable. Make sure when reconnecting the cables, they are tight.

**ATTENTION: MANDATORY READING
INSTALLATION UPDATES - PAGE 4**

WARNING!

To reduce the risk of injury, do not permit children to use this product unless they are closely supervised at all times.

WARNING!

To reduce the risk of injury:

- a. *The wet surfaces of steam enclosures may be slippery. Use care when entering or leaving.*
- b. *The steam head is hot. Do not touch the steam head and avoid the steam near the steam head.*
- c. *Prolonged use of the steam system can raise excessively the internal human body temperature and impair the body's ability to regulate its internal temperature (hyperthermia).*

WARNING!

Hyperthermia occurs when the internal temperature of the body reaches a level several degrees above the normal body temperature of 98.6° F. The symptoms of hyperthermia include an increase in the internal temperature of the body, dizziness, lethargy, drowsiness, and fainting. The effects of hyperthermia include:

- a) *Failure to perceive heat;*
- b) *Failure to recognize the need to exit the steam bath;*
- c) *Unawareness of impending risk;*
- d) *Fetal damage in pregnant women;*
- e) *Physical inability to exit the steam bath; and*
- f) *Unconsciousness.*

WARNING!

The use of alcohol, drugs, or medication can greatly increase the risk of hyperthermia.

Limit your use of steam to 10 – 15 minutes until you are certain of your body's reaction.

Excessive temperatures have a high potential for causing fetal damage during the early months of pregnancy. Pregnant or possibly pregnant women should consult a physician regarding correct exposure.



Caution: Do not place wiring in close proximity to hot water or steam pipes.



Attention: *If the installation and operation instruction are not read or understood, do not install. Install the controller based on the installation instruction.*

If the controller is installed outside the steam room, the temperature sensor must be installed in the steam room. To prevent overheating, operate the controller as described in this manual only.

****Not for Space Heating Purposes**

DANGER!

Afin de réduire les risques de blessures, ne jamais autoriser des enfants à utiliser ce appareil, sauf s'ils sont étroitement surveillés, à tout moment

DANGER!

- a) *Les cabines où de la vapeur est introduite peuvent comporter des surfaces humides et donc glissantes. La plus grande prudence est de rigueur au moment où l'utilisateur pénètre, ou quitte la cabine*
- b) *La tête d'injection de la vapeur est à haute température; il faut veiller à ne pas entrer en contact avec cette tête d'injection. De plus, il faudra éviter le contact avec le jet de vapeur à proximité de la tête d'injection.*
- c) *Soumis, d'une manière prolongée aux températures occasionnées par un jet de vapeur, la température interne du corps humain est susceptible de dépasser le seuil où celui-ci s'auto-régule, provoquant l'hyperthermie.*

DANGER!

Le corps humain entre en hyperthermie quand sa température interne dépasse de plusieurs degrés sa température normale de 98.6° Fahrenheit, soit 37°Celsius.

La personne en état d'hyperthermie souffre d'étourdissements, est léthargique, assoupie et susceptible d'évanouissement.

Les effets de l'hyperthermie comportent:

- a) *Insensibilisation à la chaleur*
- b) *L'absence de volonté de quitter le local sous température élevée*
- c) *Inconscience du danger imminent*
- d) *En ce qui concerne les femmes enceintes, la possibilité de réactions nocives au niveau du fœtus. Les femmes enceintes, ou potentiellement enceintes, doivent préalablement consulter un médecin*
- e) *Engourdissement physique menant à l'incapacité de quitter le local*
- f) *Perte de connaissance*

DANGER!

L'usage de drogues, d'alcool, de médicaments est susceptible d'augmenter les risques d'hyperthermie dans de larges proportions.

Avant utilisation, il y a lieu de limiter votre usage de la vapeur à 10-15 minutes pour tester les réactions de votre corps.

Pendant les premiers mois de grossesse, des températures excessives sont susceptibles d'engendrer des dommages, à issue fatale, au fœtus. Les personnes enceintes, ou probablement enceintes, doivent obtenir un avis médical en ce qui concerne les conditions auxquelles elles peuvent se soumettre.

Avertissements

- Ne pas installer de fils à proximité d'eau chaude ou de conduits de vapeur
- La tête d'injection de vapeur ainsi que l'orifice de débit de vapeur sont à hautes températures – Éviter le contact de ces appareils sous peine de brûlures.
- Cet appareil ne doit pas être utilisé à des fins de chauffage ambiant
- Avant toutes opérations de maintenance et de nettoyage, déconnecter la source de courant

Installation

- Installer la tête d'injection de vapeur entre 15 et 30 cm au-dessus du sol. Si le bain de vapeur se trouve dans la baignoire ou la salle de bains, installer la tête d'injection de vapeur à 15 cm au-dessus de la baignoire

Le jet de vapeur doit être dirigé vers le bas. Entourer le filet du tuyau de vapeur de quelques couches de Teflon, visser la tête d'injection de vapeur et visser manuellement.

MANDATORY READING

INSTALLATION UPDATE BULLETIN

INSTALLATION OF 9KW AND 12 KW STEAM GENERATORS

When connecting the power supply for the 9KW and 12KW steam generators, there may be some difficulty connecting the 8 and 6 gauge wires into the terminal block. In order to make these connections as easy as possible, you can remove steam generators wires from the terminal block and wire nut the wires directly to your power source. This will make the electrical connections easier.

INSTALLATION OF 6KW

When using the connection terminal block, the connection can become loose due to expansion and contraction from the heat and the small vibrations caused when the unit is running. After the initial installation the connection must be checked after 30 days to make sure the connection is still tight (tighten if necessary), then the connection should be checked about every 6 months after that.

If desired, connections may be made directly not using the terminal block. Follow the instructions above for the 9kW and 12kW steam generators.

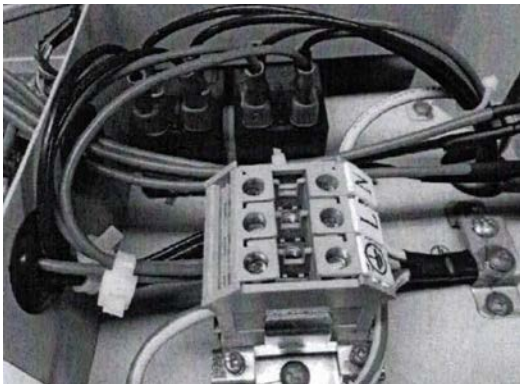

Terminal block connected

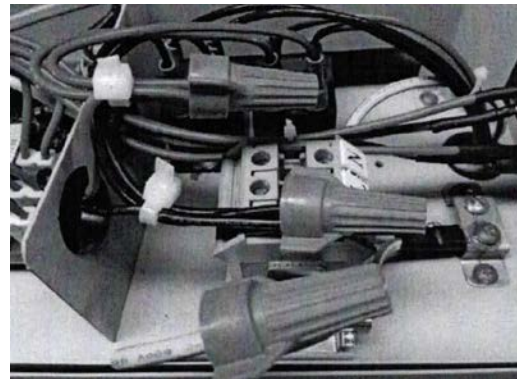

Terminal block by-passed using wire nuts

INSTALLATION OF THE KEYPAD EXTENSION WIRE

When connecting the keypad and/ or the keypad extension wire to the Steam Generator cable, **DO NOT TWIST THE PLUGS**. They are to be **PUSHED** together, twisting will damage the pins and it is not covered under the warranty.

The Temperature detector foundation and locknut for temperature detector foundation (escutcheon) for the temperature sensor, comes in a bag inside of the keypad box. Also included is the Steam Head.

When attaching the steam head to the steam line, do not tighten the steam head all the way down. Doing so will restrict the flow of the steam. You should thread the steam head about 3/8 inch onto the steam line.

Light kits are available for the GS08 Steam Generators. **White light and chromotherapy lights are available.** Call 866-783-2661

Part 1: Steam Generator

USER INSTRUCTIONS



Attention: We are not responsible for the malfunction and damage from improper installation that does not comply with the user's manual.

1. Make sure the model and the accessories are correct, including the voltage 220V input.
2. Make sure the steam power is matched with the dimensions of the steam room. Pay attention to the steam room's cubic feet measurements and construction materials. See below on how to choose your type of machine.
3. Make sure to read this manual carefully for correct and effective use.
4. We shall not be responsible for the product damage or malfunction caused by self-installation or the operation procedures which is not in compliance with the Operation and Instruction Manual.
5. Please check the contents when the package arrives to ensure it is in good condition. If you find any damage in the package, please contact the transportation company or the supplier to claim any damage.
6. This product must be used indoors.

CHOOSE YOUR TYPE OF MACHINE

Measure the length, width, and height in feet of the current steam shower or bathtub room.

Example; L:7 x W:5 x H:8 = 280 Cubic feet x 2 to get complete cubic measurement

Note: Multiplying the cubic feet by two is done to account for heat loss due to the room having natural stone such as granite or marble, exterior walls, ceiling height exceeding 8 feet, ceramic tile, or glass walls.

6kW: Heats rooms 140-320 cubic feet

9kW: Heats rooms 320-460 cubic feet

12kW: Heats rooms 460-700 cubic feet

MAINTENANCE

Perform water discharge operation after each use. The unit will drain automatically 20 minutes after use.

1. Wait for the completion of automatic water discharge after each time of using the steam engine to make sure the water in the tank is discharged completely before cutting off power supply.
2. There should not be any leaking or damage to the steam engine, steam nozzle, components and pipes. They should be checked monthly.
3. Clean the water supply pipes of the steam engine once a year.
4. Check all the connections, water, and electric, to see if they have become loose or are damaged due to overheating.
5. Check the calcium build up in the water tank and on heating element. If the scale is thick, clean it (use diluted citric acid to soak for 15-30 minutes).
6. Remove the water level sensor needle four times per year to clean the scale off the needle.

CHOOSING PROPER LOCATION

Recommended locations for proper installation:

1. The steam box should not be located further than 16 feet away from the steam room.
 2. The steam generator should not be installed in the steam room.
 3. The steam generator should not be installed outdoors or in any place that will influence the security of the machine.
 4. Do not install it in any places where the water might freeze.
 5. Do not install near flammable objects or chemicals (coal, gas, etc.)
 6. The steam generator should be installed in a dry and ventilated place.
 7. Make sure the steam generator is secured on the wall and is horizontally positioned.
 8. On the other three sides, there has to be at least 6 inches of space left between steam generator and any other object.
 9. The place where the machine is installed must be accessible for cleaning and possible service work.
 10. The steam generator should be in a close proximity to a drain for convenient Water Drain Valve hook-up.
 11. After use, the steam pipe, safety valve, drain valve, water pipe, steam outlet is still very hot.
 12. Place steam outlet away from bathers.
- Attention:** install an exhaust fan outside of the steam room so that it can expel any excess steam for proper ventilation.
13. The shorter and straighter the steam lines, the more efficient they will be.
 14. The unit should be slightly higher than the steam outlet to allow condensation to drain out of the steam head.



Attention: The steam generator (including the controller) is ETL approved.

INSTALLATION DRAWING OF THE STEAM GENERATOR

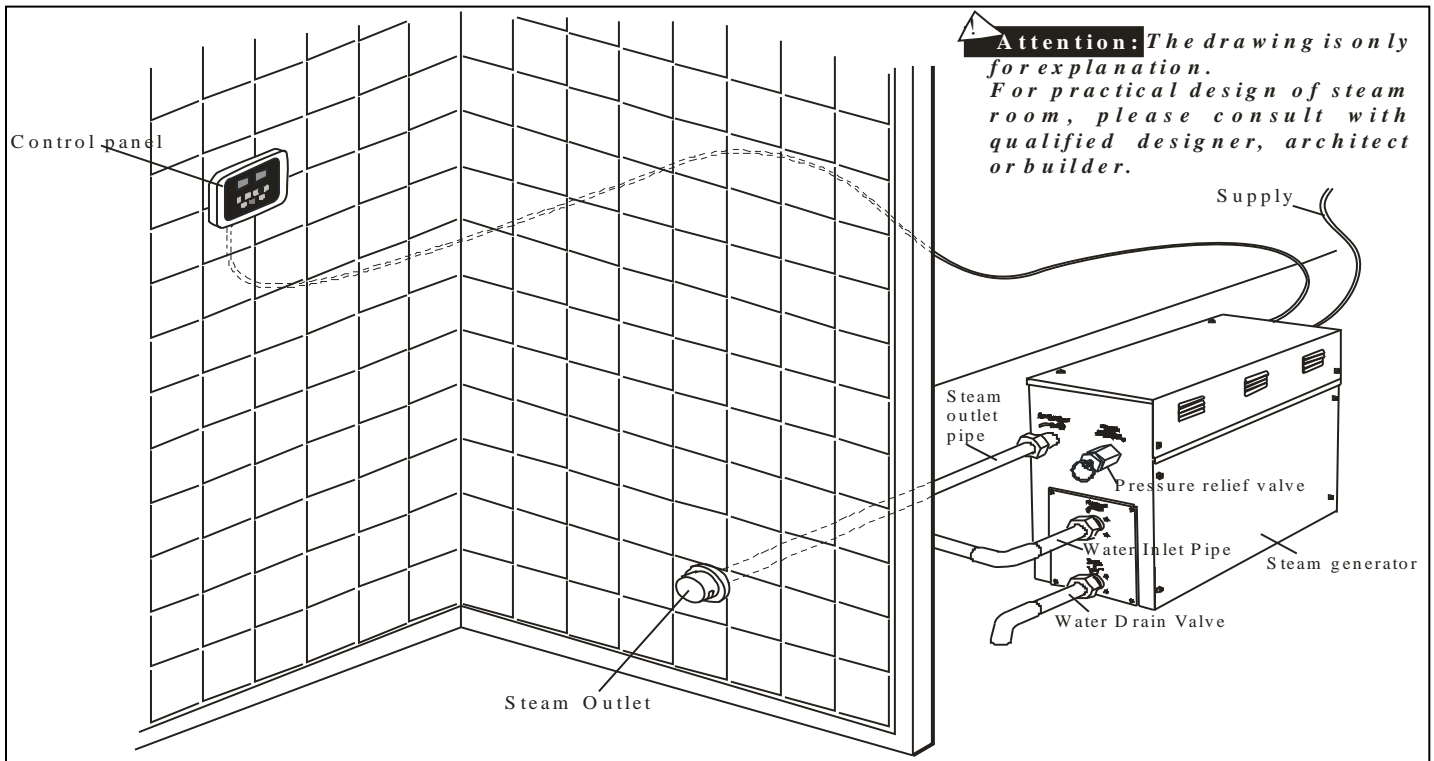

INSTALLATION OF PIPELINE



Attention: The installation of all the pipes should be completed by qualified plumbers or technicians.

1. Use brass or copper pipes only.
2. Do not use black, galvanized or PVC pipes.

Water supply pipe (1/2") PVC or PEX is adequate

1. Connect cold water pipe to water inlet.
2. Install shutoff valve in the water supply pipe. The shutoff valve should be installed in a place where it is easily operated in case of emergency.
3. Clean the water supply pipe completely before connecting it to the steam engine.
4. It is suggested that a water filter should be installed in the water supply pipe.
5. The water pressure should be no less than 20 pounds/square inch (psi), and no more than 75 (psi). If necessary, decrease or increase the pressure accordingly. Higher water pressure can cause banging when filled with water.

Steam pipe (6kW & above: pipe size 3/4")

1. Do not install any valves in the steam pipes. The steam line can never be obstructed.
2. Install a brass or copper steam pipe (6kW & above: pipe size 3/4") as connector between the steam outlet and the steam nozzle.
3. The insulation material used to insulate the steam pipe should be resistant to temperature as high as 248° F or higher.
4. Do not bend the pipe so that the cooled water will stay in the curve of the steam pipe.
5. The shorter the steam pipe, the better. Try to decrease the number of elbows and avoid abrupt turns. Use 45 degree bends instead of 90 degree T.
6. Have no valleys or dips in the output steam line.
7. Do not connect the drain valve into the steam line.
8. Do not connect the pressure release valve into the steam line.
9. Make sure the steam line is well insulated.

Steam nozzle (6kW & above: pipe size 3/4")

WARNING!

The steam nozzle and steam outlet are very hot! Avoid installing the steam nozzle near steam bathers.

1. Install the steam nozzle 6-12 inches above the ground.
2. The steam spray outlet should be installed face down. Wrap a few circles Teflon tape around the threads of the steam pipe, install the steam nozzle and tighten with hands.



DANGER!

1. Installer la tête d'injection de vapeur entre 15 et 30 cm au-dessus du sol. Si le bain de vapeur se trouve dans la baignoire ou la salle de bains, installer la tête d'injection de vapeur à 15 cm au-dessus de la baignoire
2. Le jet de vapeur doit être dirigé vers le bas. Entourer le filet du tuyau de vapeur de quelques couches de Teflon, visser la tête d'injection de vapeur et visser manuellement

Note: Aromatherapy oils are placed in the indentation at the top of the steam nozzle.

Attention: In order to protect the steam nozzle, do not use any tools to tighten that will scratch finish, use a little soapy water and soft sponge to wipe, and do not use corrosive chemical solutions or abrasive cleaning tools.



Attention:

Please consult your distributors of building materials like acrylic, fiberglass or other heat-resistant material around the installation and position of steam nozzle. It is suggested that MS-103412 heat resistant material is used.

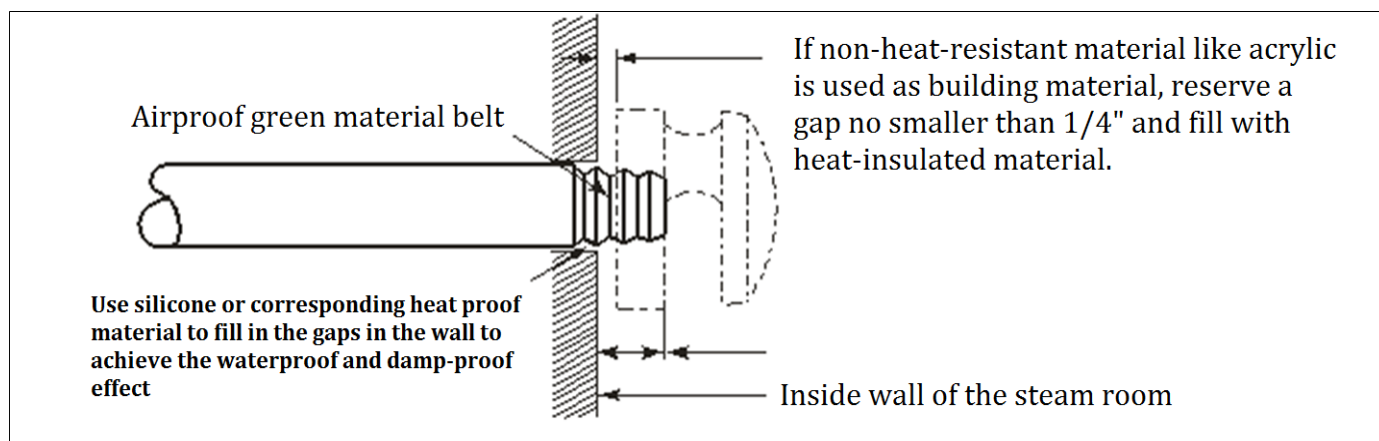

Drainpipe (1/2")

According to national and local codes, the steam engine drain valve should be equipped with drainpipe. The drainpipe must be able to handle 200 degree water. The steam engine will drain water on its own after 20 minutes.



Attention: drainpipe should not incline upwards.

Safety valve (Pressure Release Valve)

1. Safety valve is to prevent too much steam pressure in the interior steam engine.
2. The pressure limit range of safety valve is 15PSI. If the pressure should become too high over this value, the valve will release the pressure.



Attention:

1. For safety, do not dismantle the pressure release valve.
2. To maintain the proper and automatic operation of pressure release valve, make sure the connection is tight.

BLUEPRINT FOR THE STEAM ENGINE

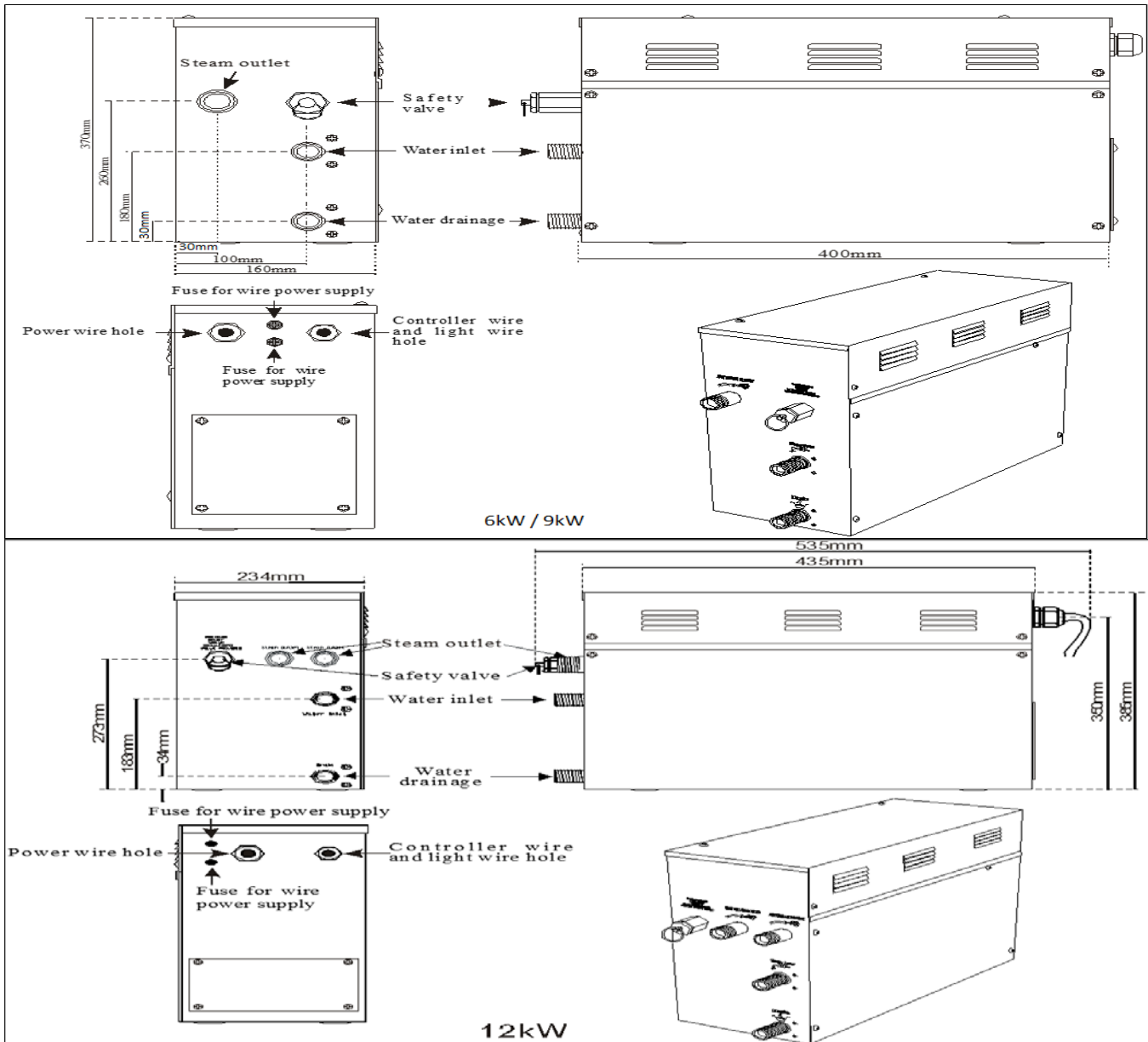

Attention: Keep the steam engine clean.



Attention: To avoid damage to the equipment, do not connect power directly to the components.

IMPORTANT: Each unit is provided with a pressure-release device (safety valve) to address overpressure due to inadvertent blockage of the output steam head or piping.

ELECTRICAL REQUIREMENTS:

Electricity supply circuitry:

1. Test the voltage of the electric supply and make sure that the steam engine is supplied with suitable electric power.
2. Insulated copper wire should be used with a heat-resistant temperature of 190°F and a specified voltage of 500V. Refer to national or local electricity code for the specifications. Refer to the ammeter for the ampere.
3. Make sure the steam engine and power supply are appropriate for each other.
4. Install an independent GFCI circuit breaker between the power supply and the steam engine.

Important: All the connections must be in accordance with national and local electricity code and be installed by professional electricians.

Note: All units are 220-240 Volts. The terminal may read N, L, G. The N is not a neutral. It is the second leg of the 220V of the power source.

AMPERE METER

Type	Applicable space of room(m ³)	Electricity supply	Electrical current Draw (Amps)	Specifications for power wire (A W G)
GS08-6Kw	5~8	220-240V / (1PH/2PH)	27.3A (30 Amps)	#10 or 6mm
GS08-9kW	10~12	220-240V / (1PH/2PH)	41A (50 Amps)	#8 or 8mm
GS08-12kW	14~16	220-240V / (1PH/2PH)	55A (60 Amps)	#6 or 10mm

ASSEMBLY GRAPH FOR POWER WIRE

Attention: To avoid the damage to the equipment, do not connect power directly to components.

WARNING!

This graph is for explanation only. For actual installation, refer to national and local electric codes and consult with a professional electrician.

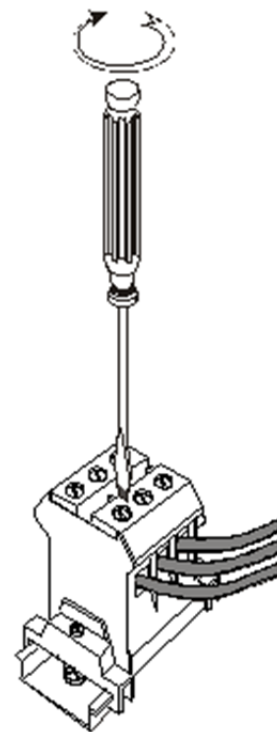
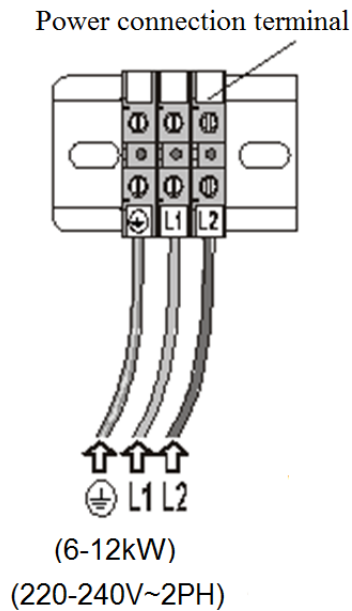

See Installation Update Bulletin on Page 4.

WIRING DIAGRAM 220-240V (1PH/2PH)

6 & 9kw Steam Generators:

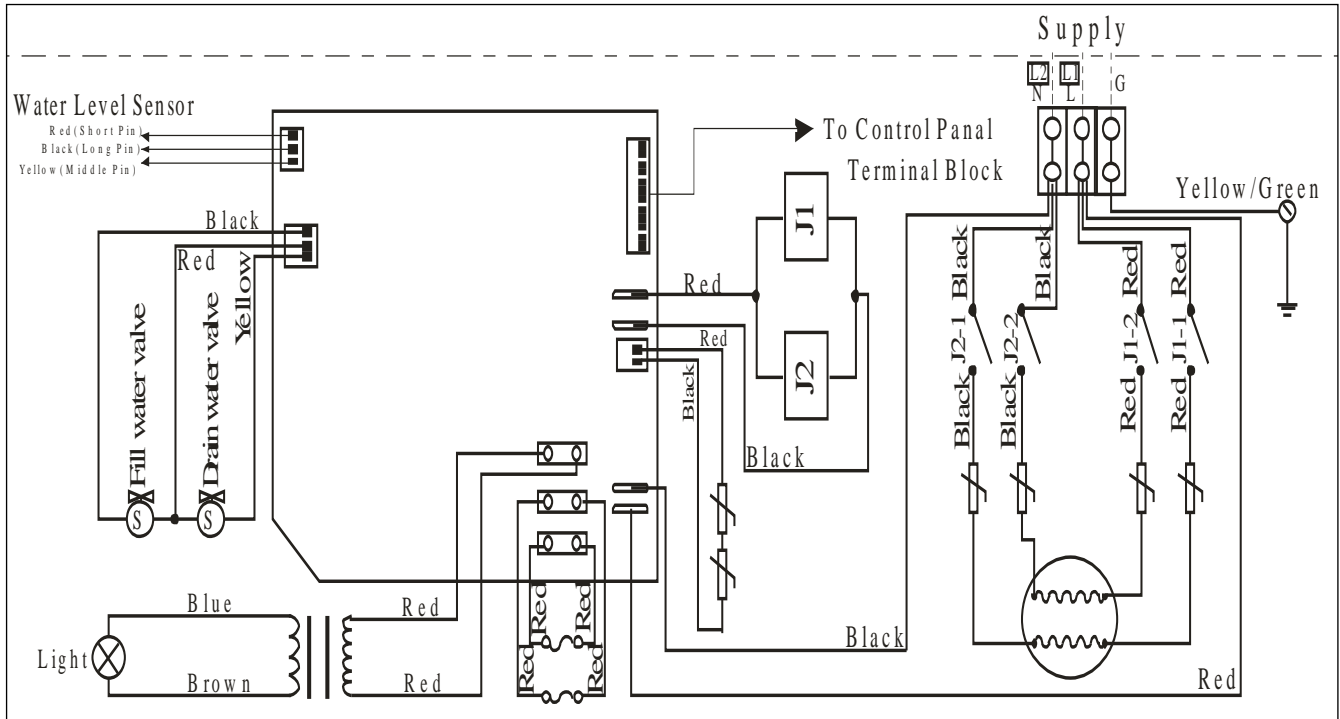

12kw Steam Generator:

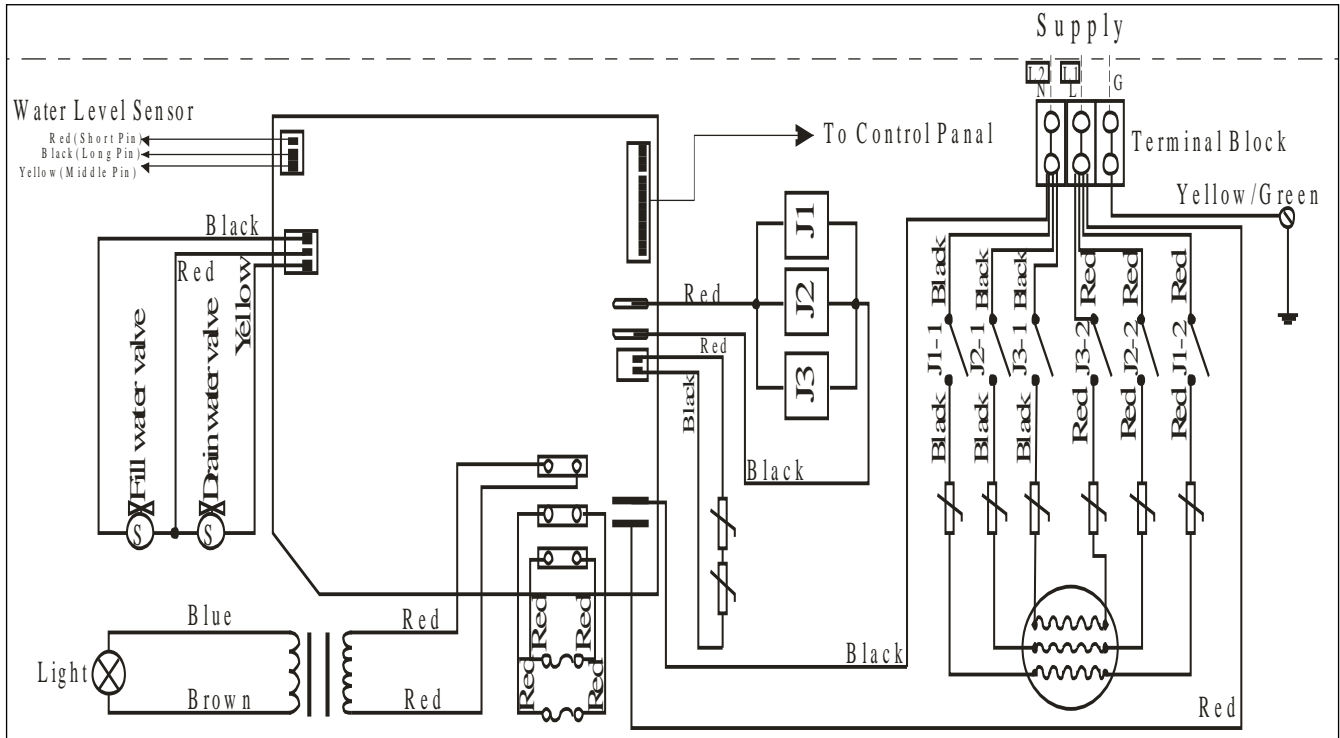

Note: All Units are L1, L2 and Ground. The neutral is Line 2 (second leg).

NOTE: NOW AVAILABLE FOR THE GS08 STEAM GENERATORS

LED Lighting Kits -White or Chromotherapy Lights

Hole for light is 1 13/16in. Diameter of light is 2 3/16in. Length of light is 1 1/2in

Drip Pan- 20x10x1 and weighs 3 lbs

For pricing, please call 866-783-2661, M-F 9:00am-5:00pm EST

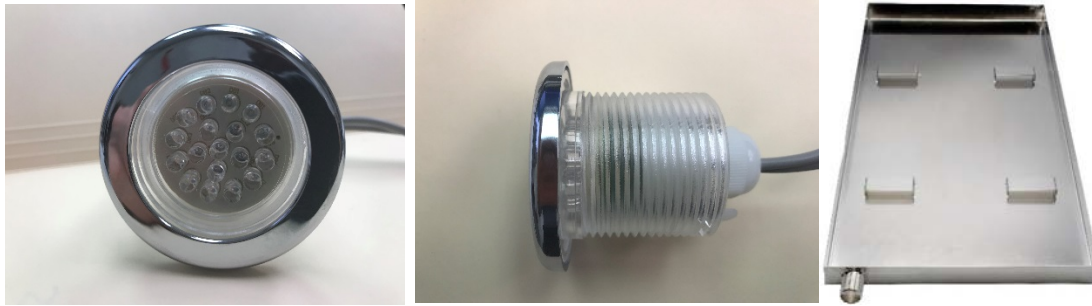

INSTALLATION OF THE TOP LIGHT

Attention: 12V output port is available for 12V DC accessories (not included).

The total draw on the 12V circuit cannot be more than 35W

Attention: Do not let the electrical components be exposed to moisture; otherwise, it may cause damage or short circuit.

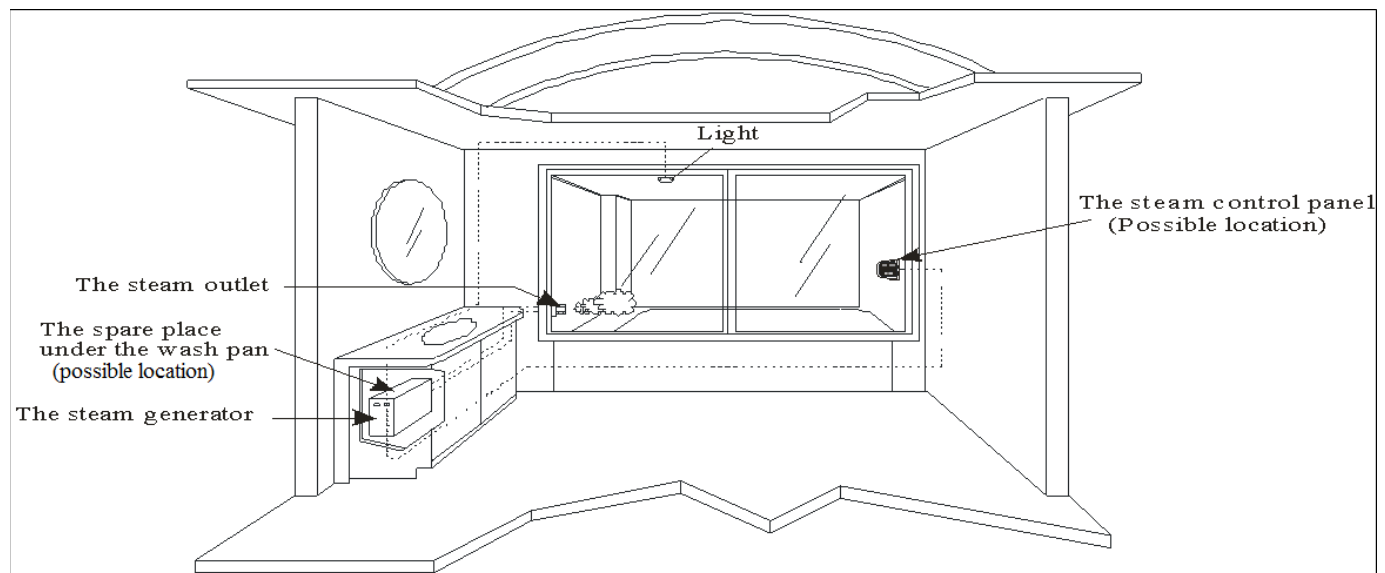

Caution: The illustration is just for explanation, the practical installation must comply with the national electric code, and installed by professional electrician.

Note: The Temperature Sensor MUST be as far away as possible from the steam outlet.
The steam outlet must be far away from any occupant to prevent burning.

STEAM GENERATOR CONFIGURATION

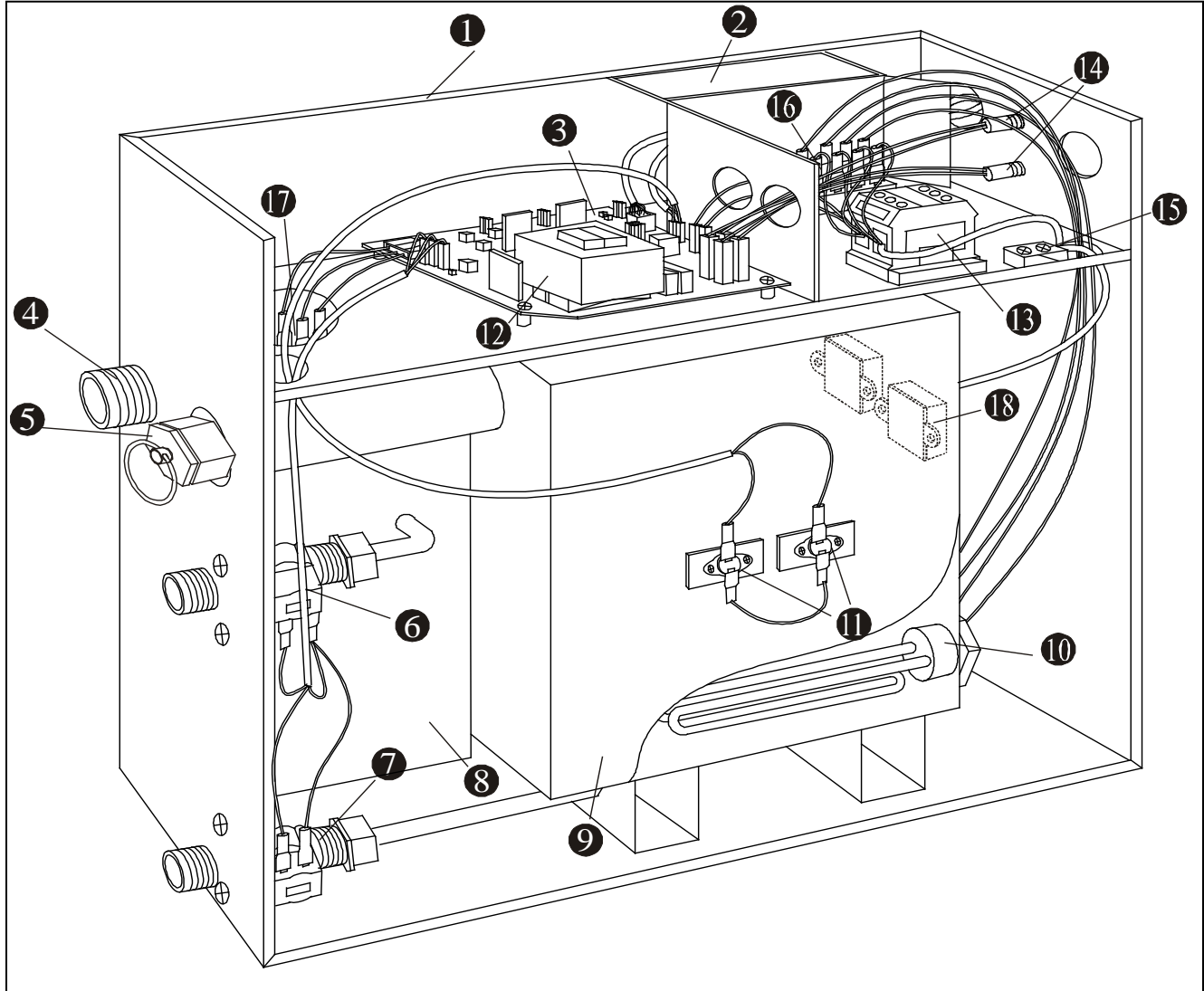

- | | | |
|---|--------------------------|---------------------------|
| 1. Enclosure | 7. Water drain valve | 13. Terminal block |
| 2. Insulation bracket | 8. Subsidiary water tank | 14. Fuse |
| 3. Circuit board | 9. Main water tank | 15. Ground connector |
| 4. Steam outlet | 10. Heating element | 16. Relay |
| 5. Pressure release valve
(safety valve) | 11. 221°F Hi-limit | 17. Water level sensor |
| 6. Water fill valve | 12. Transformer | 18. 221°F Manual Hi-limit |

TROUBLE SHOOTING:

Trouble	Causes of Trouble	Trouble-Shooting Method
The machine does not start when power is supplied	<ol style="list-style-type: none"> 1. The fuse is burned 2. The wire connection terminal is loose 3. Bad Contact in the connection wire between the controller and the steam engine 	<ol style="list-style-type: none"> 1. Change the fuse (on the shell 0.8A/250V) 2. Plug-in the wire connection terminal 3. Make sure the steam engine and controller are in good contact. Check pins on controller cable
GFCI switch breaks automatically	<ol style="list-style-type: none"> 1. The wire connector is damp or damaged 2. The heating element is damaged 	<ol style="list-style-type: none"> 1. Check whether the wire connector is damp or damaged, and dry with dryer if dampened 2. Change the heating element
When the machine is started, hot water comes out from the drain with little or no steam	<ol style="list-style-type: none"> 1. The water drainage valve is broken 	<ol style="list-style-type: none"> 1. Change the water drainage valve
The display screen on the control panel does not display (see page 1)	<ol style="list-style-type: none"> 1. The power wire is not connected properly. The connection plug between the control panel and the electrically-controlled box is loose (check pins) 2. Trouble with plug board 	<ol style="list-style-type: none"> 1. Check whether the connection plug between the control panel and the electrically-controlled box has become loose. 2. Change a plug board
Water leakage	<ol style="list-style-type: none"> 1. The water pipe connector is loose or broken 2. Water leakage in the water input valve or the water drainage valve 	<ol style="list-style-type: none"> 1. Tighten the loose connector and/or change the broken pipe 2. Change the water input valve or the water drainage valve
No steam when starting the machine	<ol style="list-style-type: none"> 1. No electricity 2. No water 3. The set temperature is too low (over 120°) 4. Trouble with wire 	<ol style="list-style-type: none"> 1. Check the power supply 2. Check the water input pipe and water input valve 3. Reset the temperature 4. Contact the distributor
The steam does not come out, there are water sounds in the machine	<ol style="list-style-type: none"> 1. The steam pipe is jammed 	<ol style="list-style-type: none"> 1. Cut power supply to check whether the steam pipe is clean
The light cannot be turned on	<ol style="list-style-type: none"> 1. The fuse is burned 2. The light is broken 3. The wire is broken 4. The plug does not have good contact 	<ol style="list-style-type: none"> 1. Change the fuse (on the shell 1A/250V) 2. Change the light bulb 3. Change wire 4. Replace plug
The display box displays normally, but with no steam output	<ol style="list-style-type: none"> 1. Too much pressure inside the steam engine, so the system breaks for heat protection 2. The heat protection wire is broken 3. Manual hi-limit switch tripped 	<ol style="list-style-type: none"> 1. Check the steam transport pipe and restore automatically after heat protection becomes cool 2. Check the heat protection wire to make sure the connection is good 3. See manual hi-limit (page 14)

Note: The main control cable has 13 pins that control everything. If the unit doesn't work or work properly, check the pins and connections at the generator and at the keypad. Make sure all connections are intact.

Instructions for Resetting the manual hi-limit switches

If the unit fills with water but does not produce steam, the issue may not be the heating element.

1. Shut off the power to the unit at the breaker.
2. Remove the top of the steam generator and make sure the power connections are tight.
3. There is an update that allows you to disconnect the wires from the terminal block and wire nut them together. This will not void the warranty and eliminates the need for checking the tightness of the electrical connections as stated on page 4 of the manual.
4. If power connections are tight go to the side of the steam generator where the electrical connections are.
5. You will see a plate that is held on by 4/6 screws, remove that plate.
6. You will have direct view of the heating elements and the power connections.
7. Above each element is a small black plastic square. In the center of that square is a reset button, push each one if you hear a click that was your problem. This is a hi-limit heat protector.
8. If that does not solve the problem, unscrew the bottom wire from each element. The elements are mounted vertically.
9. If you have a voltage tester set it to tone, touch the top element terminal with the terminal below it.
10. You should get a buzz, if you do the element is good.
11. Do the same thing for the second element.
12. If there is no sound the element is bad and needs replacing.

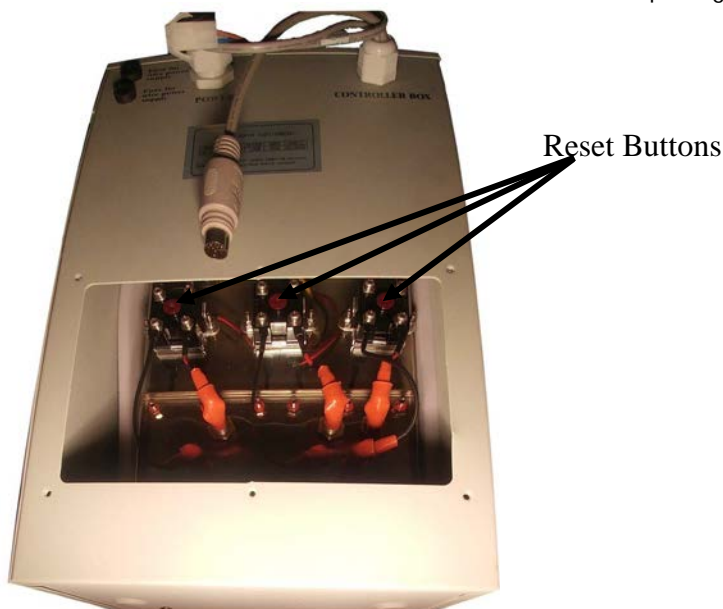

SPECIFICATIONS

Important: The list below is for reference only. In actual checking and repairing, based on the national and local codes, ask professional service personnel for advice.

Power Output	6kW	9kW	12kW
Potency Error	±10%	±10%	±10%
Duration	>1500V	>1500V	>1500V
Resistance	>20W	>20W	>20W
Steam Pressure	0.14MPa	0.14MPa	0.16MPa
Steam Volume	180	260	360
Steam Production Time	4-8 mins	4-8 mins	4-8 mins
Water Tank Volume	5.7L	5.7L	12L
Applicable space of the room (m ³)	5-8	10-12	14-16

Important: The parameter listed in the above table may vary from place and temperature, please consult a qualified designer or architect for more detailed use.

NOTE: Steam Bath Generators are considered to be able to operate above atmospheric pressure in abnormal operation and shall therefore comply with UL clause 64.8.

PART 2: CONTROL PANEL



Attention: Before installing the controller, make sure the steam generator is shut off otherwise damage may occur.

Do not use a controller that is not specifically designed for the steam generator, do not use the controller to operate steam generator of other brand.

The instructions include important safety, operation and maintenance information.

Keep the instruction manual handy.

If the steam generator is damaged or does not operate normally, do not continue to install or use.

Note: When connecting the keypad wire, push the plugs together. Do not twist.

CONTROL PANEL BLUEPRINT

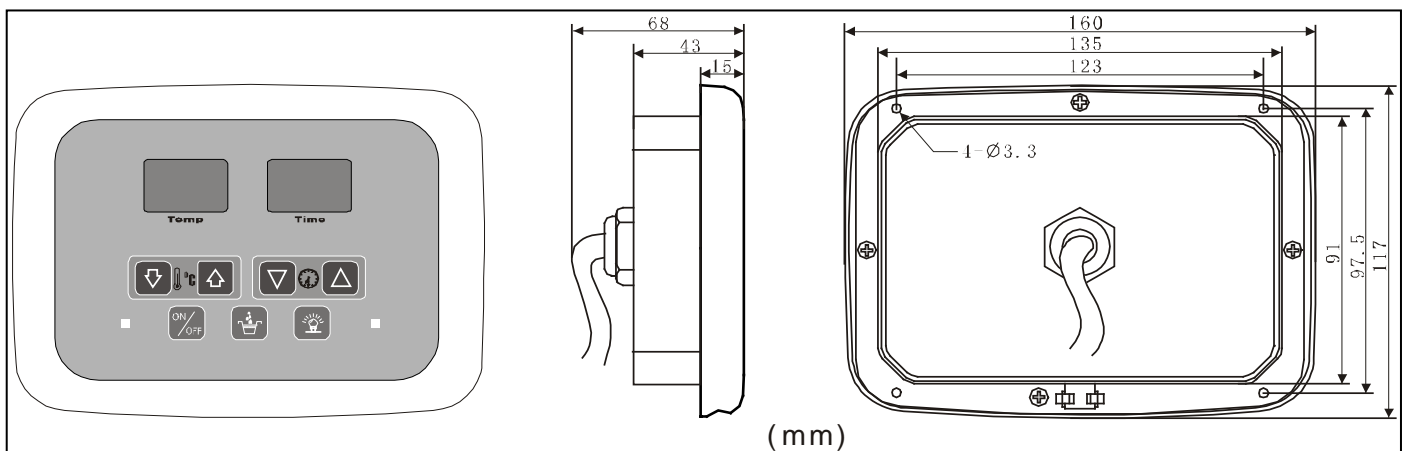

CONTROLLER INSTALLATION INSTRUCTIONS



Attention: Before installing the controller, make sure the steam engine is shut off.

Step one

Determine the installation location of the controller.

For installation:

1. 4 -5 feet away from the ground.
2. **Locate controller on separate wall from steam nozzle.**
3. Do not expose yourself to the direct spray of steam.

The controller wire is 1.5 feet long with a controller extension wire going to the steam engine being 19.5 feet long. Installation of controller panel should be in a position **not more than 21 feet from the steam engine.**



Attention: Do not install the controller under the water pipe or in a position where it will be sprayed with water.

Step two

Drill a round hole of 35mm in diameter in a chosen position. Or see note.

Step three

Pull the controller wire through the round hole, connect it to the corresponding wire in the engine.



Attention: Do not over tighten or clip the controller wire.

Step four

Start the power for the steam engine, check and adjust connection, check each item on the keypad to make sure everything is working properly.



Attention: Before setting the controller, make sure the steam engine is shut off.

Step five

Remove the paper at the bottom.

To achieve good adhesion, make sure surface is clean and dry.

Step six

Locate the display screen at the 12 o'clock position, and press tight. Adhere controller to the wall.



Attention: Level controller.

NOTE: The controller/keypad can be mounted flush on the wall. A rectangular opening that is 5 3/8"x3 5/8" needs to be cut out.

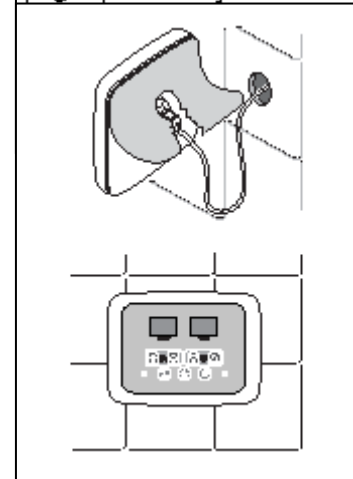
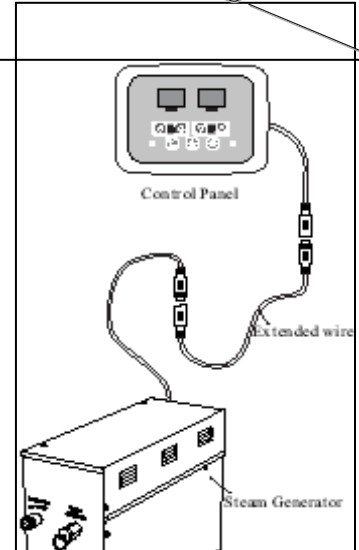
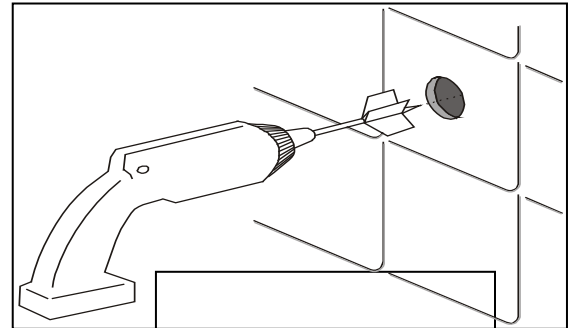

TEMPERATURE DETECTOR INSTALLATION

1. The position of the temperature sensor should be about head high where occupant will be sitting. Avoid installing near the steam outlet.
2. As shown in Fig.1, drill a small hole (10mm) in the selected position.
3. Apply silicone along the edge of the back of the detector foundation (as shown in Fig.2).
4. Use a locknut to lock the detector foundation. (As shown in Fig.2)
5. Push the temperature detector and go through the back of the detector foundation (As shown in Fig.3)
6. The temperature detector should be installed by extending about 1cm from the front of the room for accurate temperature.
7. Apply silicone to the back and set the detector. (As shown in Fig.3)

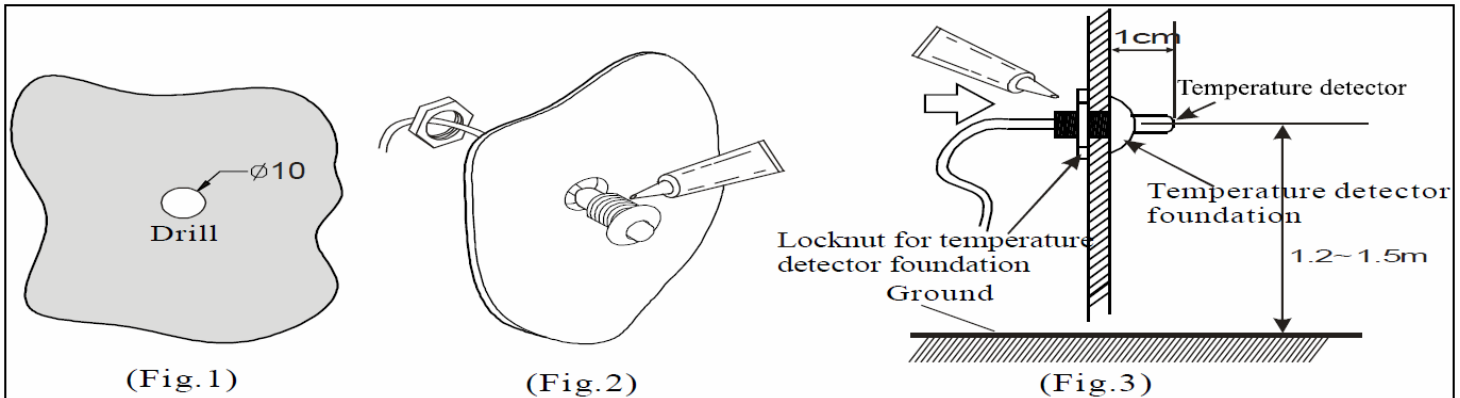

CONTROLLER PANEL ILLUSTRATION

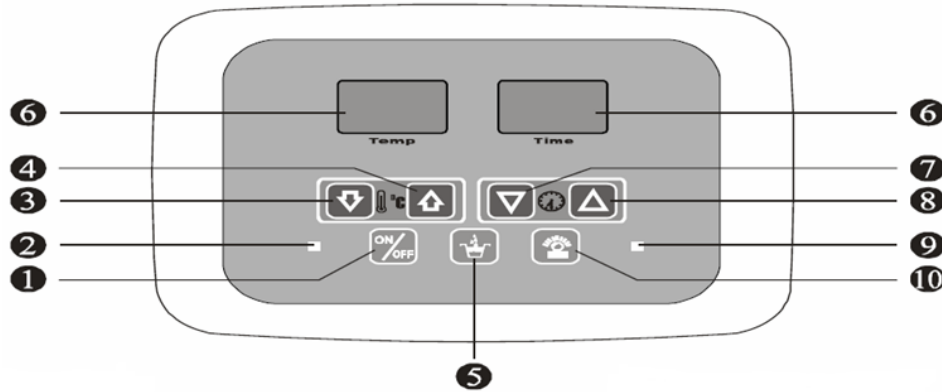

- | | |
|---------------------------------------|-------------------------------|
| 1. Power ON/OFF | 6. LED Screen |
| 2. Steam Indicator LED | 7. Steam Time Adjust Key—Low |
| 3. Steam Temperature Adjust Key--Low | 8. Steam Time Adjust Key—High |
| 4. Steam Temperature Adjust Key--High | 9. Power Indicator LED |
| 5. Water drain Key—Manual Override | 10. Mood Light ON/OFF |

Note: The unit will automatically drain 20 minutes after the unit has been off.

OPERATION INSTRUCTIONS

1. When power supply is applied to the steam box system the RED stand-by light (#9) will be illuminated. (see **Illustration of the controller panel** for location)
2. Pressing the ON/OFF button will start the system. The steam box will fill with water. This will take a few minutes; the water may cycle on and off a few times as the water tank fills. This is normal operation. The display will show ambient Temperature and Running time - 8 hrs.
3. When the Red light next to the ON/OFF button becomes illuminated, the system is operating and will start generating steam in 4 – 8 minutes. If it starts to flash, it indicates a lack of water in the tank.
4. Pressing the UP and Down arrows under the temperature display will adjust the temperature accordingly. The temperature range is 25°C to 68°C or 78°F to 150°F. The unit will cycle on and off to maintain the set temperature. See #7 for instructions on switching between Fahrenheit and Celsius.

Once the user has adjusted the temperature to their preference, the temperature lights will blink several times and the time and temp will be the active setting.

5. When system is on, press UP or DOWN triangle keys on control panel to adjust running time, meanwhile, time display window shows the time you desire. The steam time range is 1 minute to 8 hours. When setting time to less than 1 hour, the time unit is by the minute; when more than 1 hour, the unit is hour and time display window will indicate "8 h" (hours).
6. When system is on, press the LIGHT key to turn on lights; press again to turn off. If applicable.
7. When system is in standby mode, press DOWN temperature key and UP triangle key at the same time. This will switch between Fahrenheit and Celsius.



Attention:

1. *Use soft cloth with soap and water to clean the controller.*
2. *Do not use abrasive cleaning tools.*

Helpful Hints:

Steam Generator does not produce steam:

If your steam shower has been working with no issues, and one day the steam generator just doesn't come on, make sure the time and temperature are set (even if you have never changed it). Sometimes the unit will reset and if the time and/or the temperature are not set, the unit will not come on.

During initial start-up, set to the maximum temperature for first time operation. Afterwards lower to preferred temperature setting.

If the unit has been operating properly and then all of a sudden water fills the tank and the steam indicator LED light goes out and there is no steam, check the 221°F hi-limit switch (page 14). If this occurs, there is a reset button at the center of the switch. Press the button. Check each button that is above each heating element and that should solve the problem.

The reset button can be tripped during shipment or as a new installation. The steam indicator LED light goes out and there is no steam, check the 221°F hi-limit switch (page 14). If this occurs, there is a reset button at the center of the switch. Press the button. Check each button that is above each heating element and that should solve the problem.

Technical Assistance:

For any information or assistance, call 866-783-2661

TO EXPEDITE PARTS REQUEST

Please visit homewardbath.com/support

If you require additional assistance,
call 866-783-2661.

WARRANTY INFORMATION & REGISTRATION

Please visit our website:
homewardbath.com/warranty-registration

Registration must be completed within **45 days**
of receipt to be valid.

A full description of the warranty is available on
the Homeward Bath website.

