

CFI FOAM, INC.

Injection Foam Products for the Cores of Concrete Masonry Units (CMU)

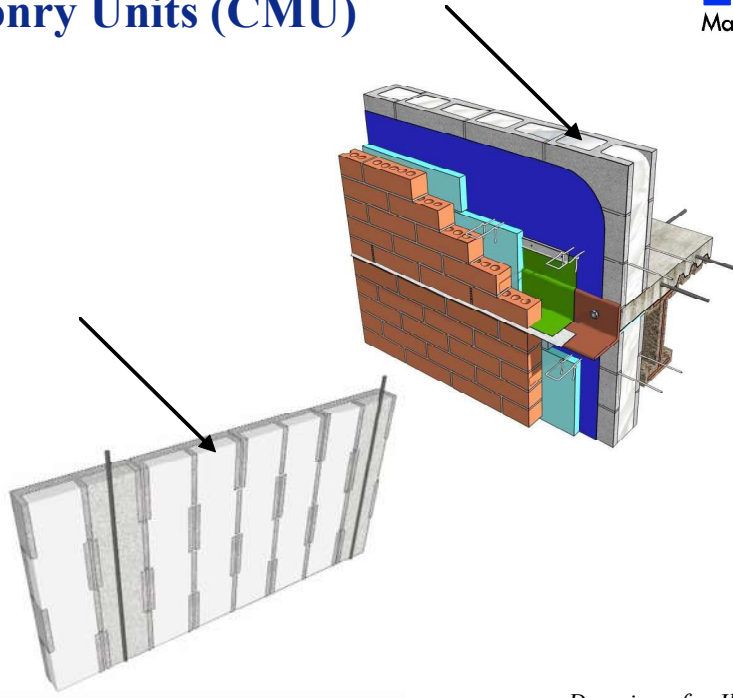

CLICK ANYWHERE on THIS PAGE to RETURN TO CONCRETE BLOCK INSULATION at InspectApedia.com

Drawings for Illustrative Purposes Only

<p>Product Description:</p> <ul style="list-style-type: none"> • R-Value per inch: 4.9 inch @ 25°F; 4.4 inch @ 75°F • Flame Spread: < 25 per ASTM E-84 @ 4" • Smoke Developed: < 450 per ASTM E-84 @ 4" • Fire Classification: Class A • STC Rating: 54-60 dB in 8" CMU walls 58-61 dB in 12" CMU walls • Shrinkage: < 0.5% • VOC Emissions: < 16 ppb • Potential Heat: < 80 Btu/lb. <p>Application: Walls can be filled with foam using either top-fill or pressure-injection techniques using 5/8" to 7/8" holes. Prior to installation, the wall should not have any standing water in the CMU cores and no visible wetness on the exterior surface. A 72-hour curing period is normally suggested prior to painting wall. Foam should not be exposed to surfaces over 190°F for an extended period of time. Foam should not be used for flotation, in horizontal applications or as a waterproofing material.</p>	<p>Basic Use: Injection Foam Insulation for Enclosed Cavity Applications.</p> <p>Since cfiFOAM products are a solid, physical characteristics such as boiling point, vapor pressure, vapor density, percent volatiles, evaporation rate, etc., do not apply.</p> <p>Color and Odor: White semi-rigid foam with minimal odor</p> <p>Density: 0.5-1.0 lb/ft³</p> <p>Usage Precautions: Ventilate well until foam fully cures.</p> <p>Hazardous Components: None present at levels above 0.1%</p> <p>Personal Protection: Safety glasses and gloves</p> <p>Testing: ASTM E-84, ASTM C-518, ASTM D-1621, ASTM E-96, ASTM D-2842, NFPA 259, ASTM D-5116</p>
--	--



cfiFOAM, Inc.
P.O. Box 10393 | Knoxville, TN 37939
800-656-FOAM (3626)
Fax: 865-588-6607
www.cfifoam.com

© cfiFOAM, Inc. - 2021

Core Foam Masonry Foam Insulation® is not associated with and is a different product from the Core Fill-500™ products manufactured by Tailored Chemical Products, Inc.

cfiFOAM Aminoplast Masonry Foam Insulation – Guide Specification (Short Form)

SECTION 07 21 19.13

FOAMED-IN-PLACE AMINOPLAST INSULATION

[Note: Elements of this Guide Specification may be adapted to SECTION 04 20 00]

PART 1 - GENERAL

DESCRIPTION OF WORK

- A. Foamed-In-Place masonry insulation for thermal, sound attenuation performance.

QUALITY ASSURANCE

- A. Manufacturing Standards: Provide insulation from a single approved source. Product components shall be of the same brand from the same approved source arriving at the site either pre-mixed according to the manufacturer's printed instructions or in unopened factory sealed containers.
- B. Installer Qualifications for Foamed-In-Place Masonry Insulation: Engage an authorized contract installer who has been trained and authorized by the product manufacturer.
- C. At the Architect's request, the Installer will provide infrared scanned images of the work prepared by a "Block Wall Scan IR" trained IR technician to confirm that empty core cells are filled with foam insulation. Insulation voids shall be foamed at no added cost to the Owner.

PART 2 - PRODUCTS

ACCEPTABLE MANUFACTURERS

- A. CfiFOAM Aminoplast Foam Insulation by CfiFOAM, Inc., P.O. Box 10393, Knoxville, TN 37939. Phone: (865) 588-4465.
- B. None.

MINIMUM PRODUCT PERFORMANCE STANDARDS

- A. Fire-Resistance Ratings: Foam shall neither add to nor detract from fire-resistance ratings of insulated fire-resistance rated CMU walls per prevailing building codes.
- B. Surface Burning Characteristics: Class A per ASTM E84; Flame Spread Index ≤ 25 ; Smoke Developed Index ≤ 450 .
- C. Thermal Resistance: R-4.6/inch @ 75°F per either ASTM C518 or ASTM C177
- D. Potential Heat: < 80 Btu/lb when tested per NFPA 259.

PART 3 - EXECUTION

INSTALLATION GUIDELINES

Fill all open cells and voids in hollow concrete masonry walls where shown on the drawings. The foam insulation shall be pressure injected through a series of 5/8" to 7/8" diameter holes drilled to access each column of block cells e.g. 8" o/c beginning approximately four (4) feet above the finished floor. Repeat this procedure at 10' to 14' intervals above the first horizontal row of holes (or as needed) until the empty core cells are completely filled. If "Hi-Flow" nozzles by CfiFOAM, Inc. are used, foam may be injected at up to twenty (20) foot vertical intervals. Patch holes with mortar and score to resemble adjacent surfaces. Insulation shall not be injected into wet walls.