

# AIR VENTS, STEAM VENTS

## Amtrol

### American Air Purgers

**FEATURES:**

- With tapping for installation on main and mounting Extrol or Fill-trol expansion tank and float valve
- Cast iron.

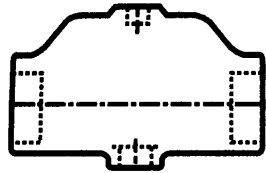

<b>Working Pressure:</b>	125 psig
<b>Top Tapping:</b>	1/8"
<b>Bottom Tapping:</b>	1/2"

Size	Mfr#	Item#
1"	443	B135-80
1-1/4"	444	B135-81
1-1/2"	445	B135-82

## Hoffman

### No. 40 Radiator Steam Vents

Float type vent with single adjustable port. For use on ordinary one pipe systems not requiring proportional venting.



Connection Size	Operating Pressure	Max. Pressure	Mfr#	Item#
1/8 angle	Up to 6 psi	10 psi	401440	40-01

## Eaton (formerly Dole)

### Steam Vents

For single pipe systems.

**FEATURES:**

- Tamper resistant.
- Accurate bi-metallic actuator.
- Internal float for positive water shut-off.
- Polished nickel finish.

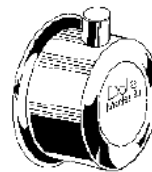

80 SERIES



85 SERIES

For Radiators Positioned	Connection	Mfr#	Item#
Near the thermostat	1/8" male angle	80-4DOLE	B148
Near boiler or in a warm room	1/8" male angle	80-5DOLE	B149
Farthest from boiler	1/8" male angle	80-C	B151
Large units or long branch	1/8" male angle	80-D	B152
Large units or long branch	1/8" straight	85-D	B152-1