

Attics and Basements: Where the Action Is

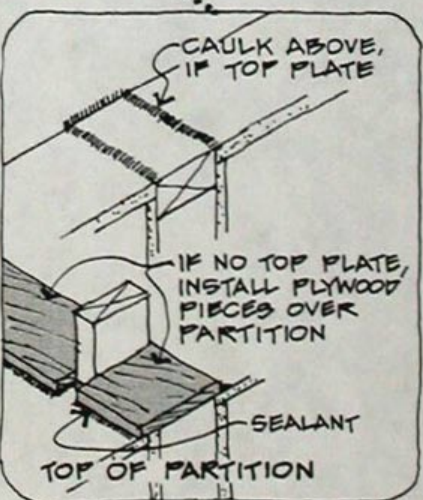
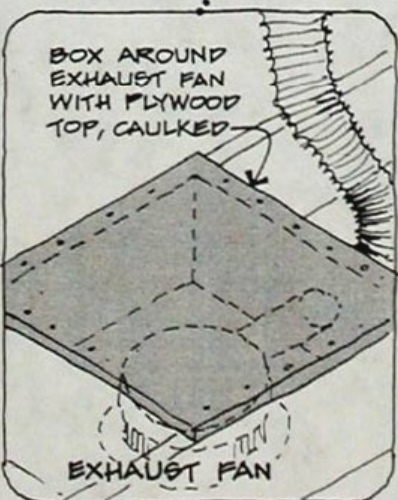
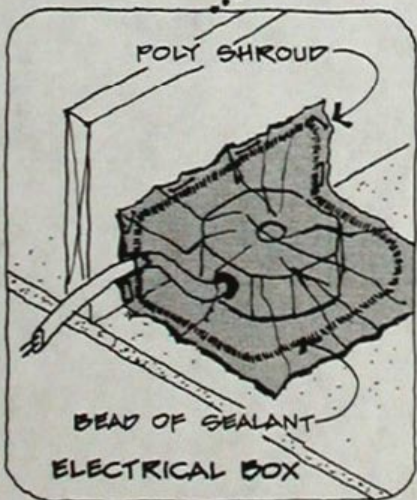
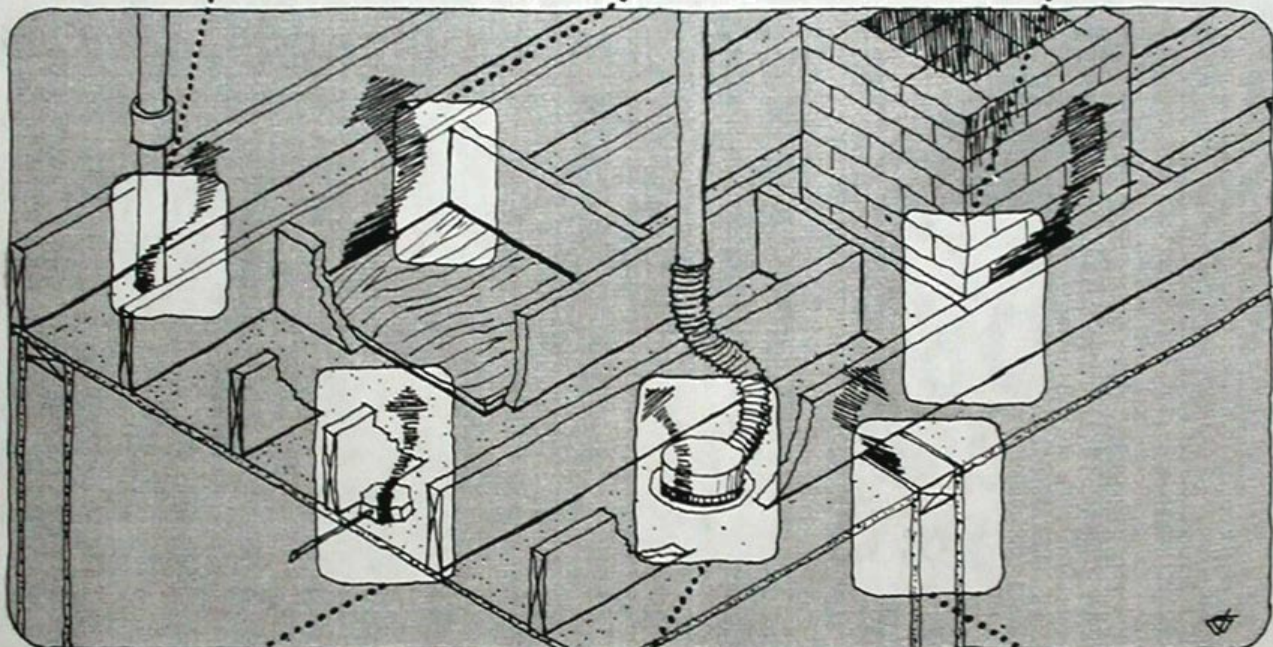
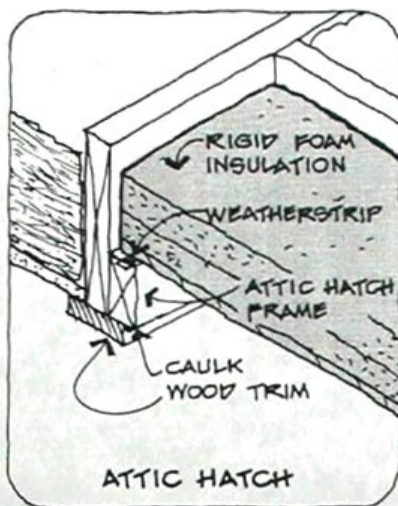
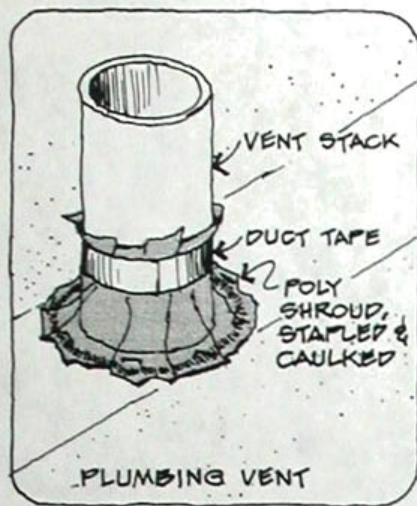

ATTIC WORK IS TOP PRIORITY. The typical attic floor is full of air leaks. The most common are through chimney chases, vent stacks, ceiling light fixtures, bath fans, and partition tops. These are best sealed before insulating. If insulation is already in place, bypasses can sometimes be spotted by dirt stains left on the insulation by passing air. An infrared scanner can quickly locate leakage points.